

Letham Village Hall Occupancy Capacities

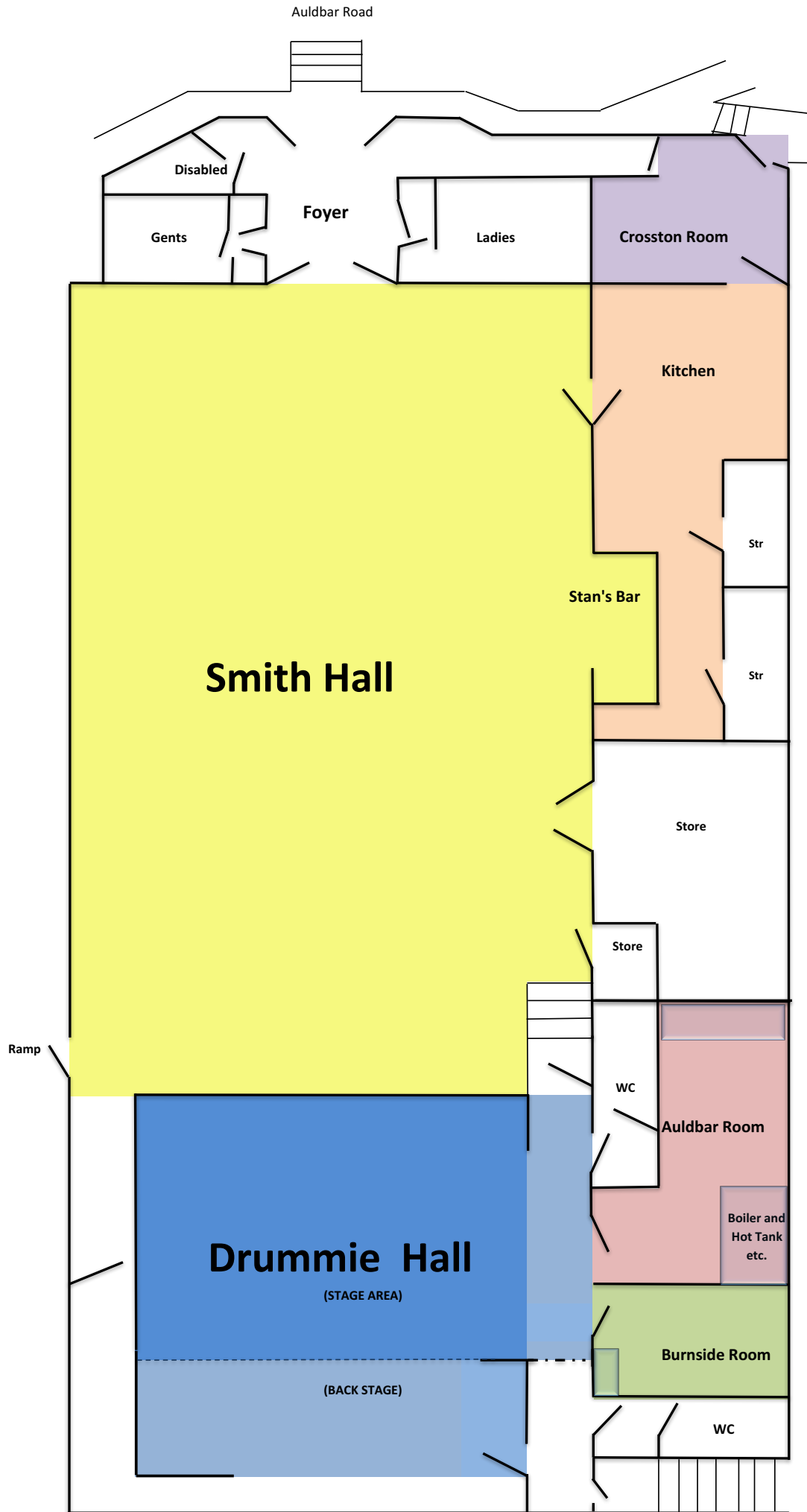

| Smith Hall | | |
|-------------------|-----|---------------------|
| Seated At Tables | 160 | |
| Seated No Tables | 200 | |
| Standing | 220 | |
| Crosston Room | | |
| Seated No Table | 14 | |
| Seated Half Table | 10 | |
| Seated Full Table | 8 | |
| Drummie Hall | | |
| Seated | 65 | STAGE AREA ONLY |
| Seated At Tables | 55 | Seated 40 |
| Standing | 75 | Seated At Tables 30 |
| | | BACKSTAGE AREA ONLY |
| | | Seated 44 |
| | | Seated At Tables 36 |
| Auldbar Room | | |
| Seated | 12 | |
| Seated At Table | 8 | |
| Burnside Room | | |
| Seated | 10 | |
| Seated At Table | 6 | |

PLEASE NOTE

Fire Regulations dictate that the maximum capacity of the hall at any time is 240 persons Max. Therefore, individual room capacities CANNOT be aggregated, in order to comply with Regulations. The figures are provided to aid facility booking decision making.